



2121 Ashland Ave, Evanston, IL 60201 | 224.999.6850



DOUBLE CLUTCH BREWING COMPANY

Experience a delicious blend of craft beer, rustic vibe, and unique event space. Situated near the North Shore Channel, Double Clutch Brewery is considered Evanston's hottest and newest brewery and restaurant, boasting a 10,000 sq. ft. space flush with exposed brick, vaulted ceilings, and a one-of-a-kind custom-car showroom.

Built in 1950 and redesigned in 2020, Double Clutch's industrial architecture offers a stunningly eclectic ambiance brimming with vibrant, neon lighting, vintage signs, and breathtaking atmosphere. When paired with our wide selection of in-house, brewed beer and delicious food and appetizers, it's no wonder our restaurant doubles as an incredibly versatile event space.

We offer flexible room rentals including our Bier Hall, Showroom, or even full-venue buyouts that include our Brew Pub area. Whether you're looking to host a corporate event, wedding, alumni reunion, or birthday, let our elegantly remodeled and rustic aura offer the perfect venue for you and your guests!

WHO ARE WE?



WE ARE A:

- Brewery
- Brew Pub
- Car Museum
- Live Music Venue
- Event Space

DID YOU KNOW?



Double Clutch Brewing Company has been the recipient of multiple awards, including:

- Brewer of the Year 2022
- Brewery of the year 2022 for small batch breweries producing 0 - 250 barrels.
- Silver Medal winner for both the Helles Lager and Helles Rauchbier Lager
- Voted Best Brew of 2023 by Chicago on Tap
- 2023 Favorite Beer at 24th Annual Chicagoland Brewpub & Microbrewery Shoutout!



ABOUT BREW MASTER

Scott Frank: Blacksmith of Beer

With a passion for both beer and cars, Scott Frank began brewing out of his garage long before Double Clutch Brewery became a concept.

Scott's vision was a unique integration: a venue that offered refreshing, pleasurable taste in both beer and cars, one that exhilarated patrons and brought both passion and fresh variety to the brewing scene.

TYPES OF EVENTS WE OFFER:

Double Clutch offers a wide selection of arranged events such as Birthdays, Holiday Parties, Corporate Gatherings, Charity Galas & Fundraisers, Car Club Socials, Weddings, Bar and Bat Mitzvahs, Brand Debut Parties, Speaker Events and more!

PRIVATE EVENTS:

Utilize any one of our unique rooms for an intimately private party for you and your guests, including the Brew Pub, Bier Hall, and Showroom!



SEMI-PRIVATE EVENTS:

Best for party groups of 40 or less, enjoy flexible event gatherings in a semi-private setting!



BUYOUTS:

We also offer rentals of our entire restaurant for all of your event needs. Enjoy complete privacy and full access to all of our rooms for a truly unique event experience!



WEDDINGS:

Experience a memorable, one-of-a-kind wedding at Double Clutch Brewery. From catering to decor, we're here to fulfill any vision for your dream wedding ceremony.



DOUBLE CLUTCH BREWING COMPANY

Private Events Spaces

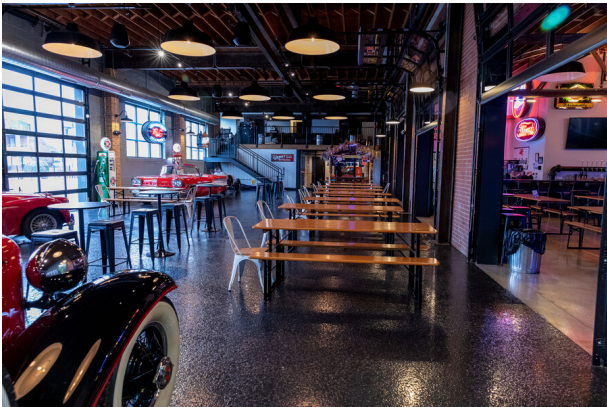

FULL SHOWROOM

With breathtaking architectural designs from the exposed steel ceiling beams, to the retractable garage doors surrounding the room, this space will enhance any event! The bold espresso colored restored wooden floors and industrial brick walls provide a warm and welcoming feel to this space. The full showroom is large enough to accommodate a typically larger event, including wedding ceremonies or receptions, but also has the opportunity to be divided into sections for smaller events. The most unique part of this room and venue as a whole is the exquisite show-car collection, with a rotating schedule of new vehicles.

Guests can opt to rent the Full Showroom and the Bier Hall. For pricing options, please connect with our event manager.

CAPACITY:

Seated: 120

Standing: 180

FOOD & BEVERAGE MINIMUM:

Minimum varies based on day and time, and ranges from \$2,000 - \$8,000.

ROOM INCLUDES:

Car Museum

Guests can opt to rent the Full Showroom and the Bier Hall.

Tables / Hightops

Guests can opt to rent the Full Showroom and the Bier Hall.

DOUBLE CLUTCH BREWING COMPANY

Private Events Spaces

FULL SHOWROOM LAYOUT

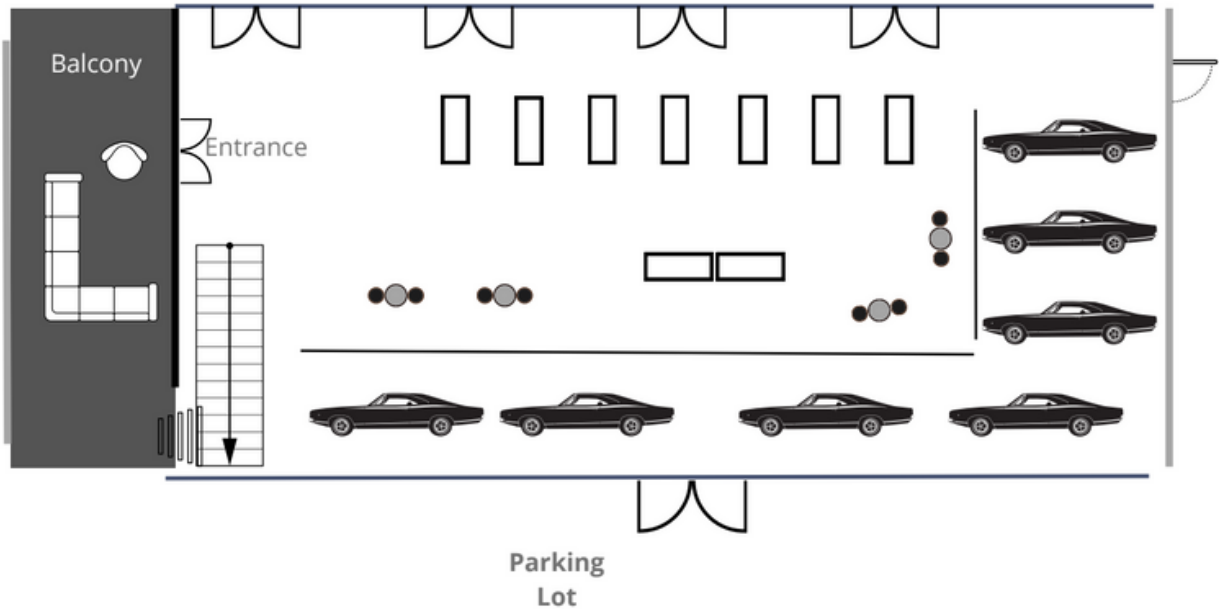

ROOM DETAILS:

Square Foot of Space - 3211Ft

9 picnic tables

4 cocktail tables

5-8 vintage cars monthly

Balcony with lounge area



DOUBLE CLUTCH BREWING COMPANY

Private Events Spaces

BIER HALL

Located in the heart of the venue and adjoining the showroom along with seven serving and fermenting beer tanks, this semi-private space is ideal for gatherings of any size! Featuring a main stage for live music, a large bar with two flat screen TVs, exposed beams on the ceiling, and retractable garage doors on the main wall, the flexibility of this area makes event possibilities endless.

Guests can opt for a partial Bier Hall rental for parties of up to 30 guests. There is no food and beverage minimum, and the space is not private/closed off to other patrons. Guests can opt to rent the Full Showroom and the Bier Hall. For pricing options, please connect with our event manager.

CAPACITY:

Seated: 110

Standing: 150

FOOD & BEVERAGE MINIMUM:

Minimum varies based on day and time, and ranges from \$2,000 - \$8,000.

ROOM INCLUDES:

AV Capabilities

- 2 TVs
- Projector
- Stage
- Full AV Band capability
- Bar
- Sound System



DOUBLE CLUTCH BREWING COMPANY

Private Events Spaces

BIER HALL LAYOUT

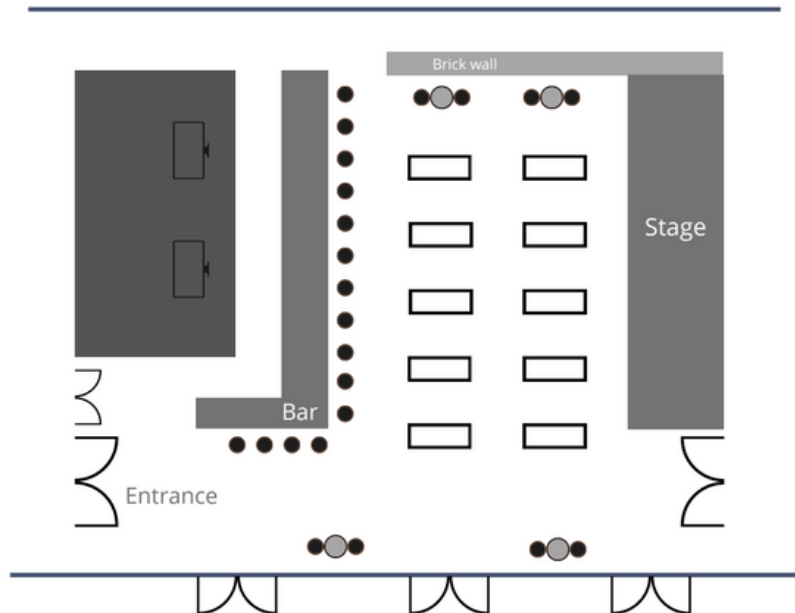

ROOM DETAILS:

Square Foot of Space - 2333FT
10 Picnic tables - 7ft
4 high cocktail tables
16 bar stools
2 large TVs
1 Projector in the wall



DOUBLE CLUTCH BREWING COMPANY

Private Events Spaces



THE BREW PUB

Enjoy a vibrantly bright and industrial-inspired dining space. Our Brew Pub features a bar, high-top seating and large garage doors for a semi-alfresco experience.

Flush with natural lighting, exposed brick, and skylight, the Brew Pub is an entertaining space that doubles as the perfect venue for private events, reunions, birthday parties, and more.

Equipped with widescreen TVs and stainless steel beer tanks, it's a perfect spot for sports and beer lovers alike!

Guests can opt to rent the Full Showroom and the Bier Hall. For pricing options, please connect with our event manager.

CAPACITY:

Seated: 60

Standing: 80

FOOD & BEVERAGE MINIMUM:

Minimum varies based on day and time, and ranges from \$2,000 - \$8,000.

ROOM INCLUDES:

- 3 TVs
- Full Bar

DOUBLE CLUTCH BREWING COMPANY

Private Events Spaces

THE BREW PUB LAYOUT

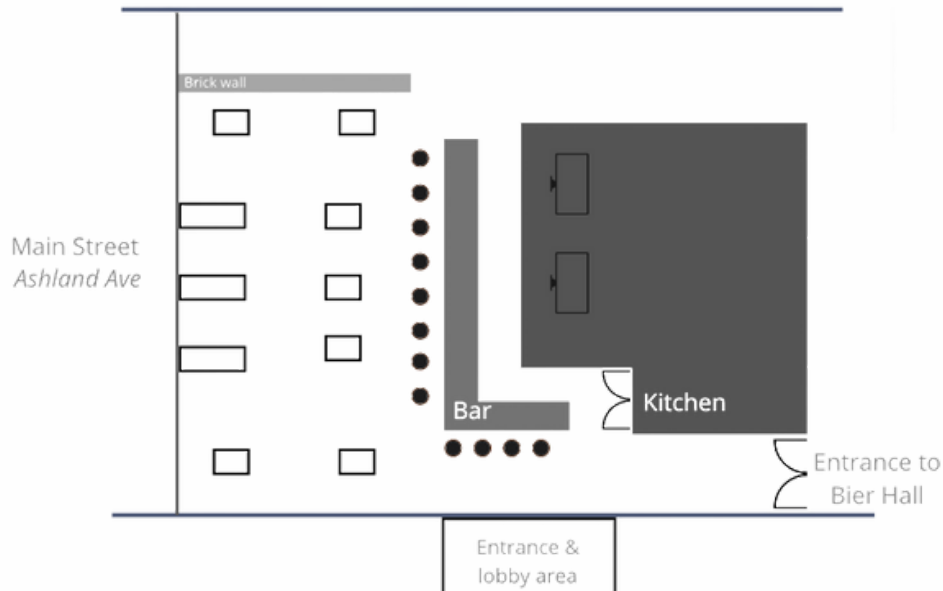

ROOM DETAILS:

Square Foot of Space - 1656FT

7 small square tables

3 high tables

16 bar stools

2 large TV







PRIVATE EVENTS MENU

FAMILY STYLE MENU

\$42/PERSON

Available for 30-100 people. Additional Appetizers are \$4.95 per person

APPETIZER..... Select 2

- House Meatballs with Marinara
- Fried Cheese Ravioli with Marinara
- Smoked Amish Wings (Buffalo, BBQ, Dragon Sauce)
- Tata's Pierogies (Classic Potato, Cheddar-Bacon, or Sauerkraut & Mushroom)
- Meat and Cheese Charcuterie Board
- Specialty Cheese Board
- Fresh Fruit & Vanilla Greek Yogurt Platter
- House-Made Hummus & Veggie Platter
- Italian Bruschetta

Additional \$2.90 per person

- Smoked Pulled Pork Sliders
- Angus Beef Sliders
- Smoked Pulled Chicken Slider
- Dill Pickle Grilled Cheese with Soup Shooter

SIDES..... Select 2

- Honey Dijon Roasted Brussels Sprouts
- Roasted Garlic Parmesan Mashed Potatoes
- Italian Vesuvio Roasted Potatoes
- Garlic Roasted Veggie Medley
- Cheesy Baked Mac 'n Cheese
- Herb Lemon Roasted Asparagus
- House German Potato Salad

Additional Sides are \$2.95 per person

SALADS..... Select 2

- Caesar Salad
- Double Clutch House Salad
- Harvest Pear Salad
- \$2.95 add on of Assorted Bread Basket with Whipped Butter

Salad Add On: Chicken/Shrimp (\$6 per person)

ENTREES..... Select 2

- Lemon Thyme Roasted Chicken with Gravy
- Herb Pork Tenderloin
- Balsamic Reduction Portabella Mushroom
- House Stroganoff with Homemade Spaetzle

Additional \$5.00 per person

- Herb Lemon Salmon Florentine

Additional \$6.00 per person

- Beef Tenderloin with Mushroom Gravy



PRIVATE EVENTS MENU

HORS D'OEUVRE MENU

APPETIZER PACKAGES

NÜRBURGRING PACKAGE

5 Items - \$35 per person

INDY 500 PACKAGE

6 Items - \$40 per person

LE MANS PACKAGE

7 Items - \$45 per person

GRAND PRIX PACKAGE

8 Items - \$50 per person

SELECTIONS

- House Meatballs with Marinara
- Fried Cheese Ravioli with Marinara
- Tata's Pierogies (Classic Potato, Cheddar-Bacon, or Sauerkraut & Mushroom)
- Smoked Amish Wings (Buffalo, BBQ Sauce, Dragon Sauce)
- Meat and Cheese Charcuterie Board
- Fresh Fruit & Vanilla Greek Yogurt Platter
- House Hummus with Veggies Platter
- Italian Bruschetta
- Crispy Cauliflower Wings
- Italian Sausage with Peppers
- Buffalo Popcorn Shrimp with House Ranch
- Double Clutch Caesar Salad
- Double Clutch House Salad

PARTY PLATTERS

(Additional Items guests can add on for parties of 25 people or more)

PASTA TRAYS

Baked Mostaccioli..... \$140

Add on \$15 (Chicken, Sausage)

Cioppino Seafood Linguini (Clams, Mussels, Shrimp).....\$240

SKEWERS

(By the dozen)

Lemon Herb Marinated Shrimp Skewer \$140

Sirloin Beef, Peppers & Onion Skewers \$100

Marinated Chicken Skewer \$90.00

Caprese Skewer \$50

ADDITIONAL SIDES

(\$2.90 per person)

- House-Smoked Pulled Pork Sliders
- Angus Beef Sliders
- Shrimp & Crab Dip Bake with Tortilla Chips
- Dill Pickle Grilled Cheese with Soup Shooter
- Connecticut-Style Lobster Roll - \$4.50 a person



PRIVATE EVENTS MENU

DCBC PREMIUM PACKAGE

\$32 PER PERSON

(Guests receive the following items)

INCLUDES

- Smoked Amish Wings - BBQ or Buffalo
- Bavarian Pretzel Bites with Beer Cheese
- Beer-Battered Sidewinders
- Kickin' Chicken Buffalo Dip
 - (w/ Corn Tortilla Chips)

GUESTS PICK 2

- House Smoked Pulled Pork Sliders
 - (w/ Slaw and Side of Pickle)
- Mini Angus Beef Slider
- Smoked Pulled Chicken Slider
- Vegan Black Bean Patty Slider with Chipotle Aioli Sauce

ADDITIONAL SIDES

Add on \$5 per person

- Original and Smoked Brat w/ Sauerkraut and Pickled Onions
- Cheesy Baked Mac 'n Cheese
- House German Potato salad
- Crispy Cauli Wings w/ Buffalo & Ranch



PRIVATE EVENTS MENU

DOUBLE CLUTCH TACO BUFFET

\$28 PER PERSON

(Guests receive the following items)

APPETIZERS

- House Chips and Pico
- Cheesy Quesadilla
 - Add Taco Chicken \$2.00 a person

TACOS: CORN AND FLOUR TORTILLAS

- Marinated Chicken Thighs
- Marinated Sirloin Steak
- Potato & Pepper Veggie

SIDES

- Authentic Mexican Rice
- Vegetarian Refried Beans

ADDITIONAL SIDES

Add on \$6 per person

- DCBC Guacamole
- Blackened Shrimp Taco (\$6 per person)



PRIVATE EVENTS MENU

BRUNCH PACKAGE

\$28 PER PERSON

(This package is exclusively for brunch hours or morning requests)

INCLUDES

- Cheddar Cheese Scrambled Eggs
- Texas Smoked Bacon
- Maple Sausage Links
- House Pancakes or Belgian French Toast
- Breakfast Potatoes with Peppers and Onions
- Toast with Jelly - White, Wheat, or Multi-Grain

ADDITIONAL SIDES

Add on's – \$5.00 a person

- Corn Beef Hash
- Fresh Fruit & Vanilla Greek Yogurt Platter
- Blueberry Muffins
- Plain and or Blueberry Bagel with Cream Cheese - Strawberry, Blueberry & Plain Cream Cheese
- Veggie Chorizo Breakfast Tacos with Chihuahua Cheese



PRIVATE EVENTS MENU

DESSERT MENU

COOKIES.....\$30.00

(By the dozen)

- Milk Chocolate Chip
- Milk Chocolate Chip w/ Walnut
- Oatmeal Raisin w/ Pecan
- Peanut Butter

BARS.....\$40.00

(By the dozen)

- Lemon
- Chocolate Chip Brownies

DESSERT BITES.....\$30.00

(By the dozen)

- Plain Cheesecake square
- Chocolate dipped square
- Cappuccino Square
- Mini Chocolate Chip Brownie
- Mini Cream Cheese Brownie
- Mini Raspberry Bar

LARGE CHEESECAKE.....\$50.00

(14 slices)

- Plain.....\$45.00
- Carmel Apple.....\$50.00
- Seasonal Pumpkin.....\$50.00
- Strawberry.....\$50.00

Ask about the GF options

WANT A CUSTOM MENU?

Work with our Executive Chef Patrick

Looking to complement your event with unique cuisine? Double Clutch Brewery recognizes the importance of a custom menu and a customized experience.

As a divisional chef, Patrick Wasserman and his team specialize in providing excellent service and delicious event concepts. From gourmet burgers to delectable handhelds, no matter the vision, Chef Patrick and his team bring flavors and events to life.

In 2006, Patrick Wasserman graduated at the top of his culinary class from St. Augustine College. Because of his creativity, keen attention to detail, and natural ability to lead a team of chefs, Patrick's instructors hand picked him to receive the National Restaurant Associations Salute of Excellence Award in 2006.

Chef Patrick has gone on to lead his current team under Vandalay Brands, one of the most successful restaurant groups in the city of Chicago, where they bring in over 40 million in sales per year at Double Clutch Brewery and other seasonal locations.



Born and raised in a Sicilian household on the southside of Chicago, Patrick grew up watching his mother and grandmother cook delicious meals in the kitchen. Rather than follow a recipe, they used their mature sense of taste, touch, and smell to decide when dishes were just right. Thus at the ripe age of 11, Patrick's passion for creating delicious food began after his grandmother taught him how to use these gifts in the kitchen.

PRIVATE EVENTS

DRINK PACKAGES

HOUSE DRAFT BEER

3 Hours: \$25 // 4 Hours: \$28 // 5 Hours: \$31

HOUSE DRAFT BEER & WINE

3 Hours: \$27 // 4 Hours: \$30 // 5 Hours: \$33

FULL BAR

Beer, Wine, & Mixed Drinks

3 Hours: \$34 // 4 Hours: \$37 // 5 Hours: \$40

VIP UPGRADE

Batched Specialty Cocktails, Hard Cider & Hard Seltzers - Additional to Full Bar, Priced Per Person by the Hour

3 Hours: \$5 // 4 Hours: \$9 // 5 Hours: \$12

NON-ALCOHOLIC PACKAGE

Soda, Juice, Tea & Coffee

3 Hours: \$7 // 4 Hours: \$10 // 5 Hours: \$13

We will have rotating guest taps for our red, white and rosé wines. We will also have a rotating hard cider, and non-alcoholic beer. If you're interested in a specific bottle of wine or guest tap, please contact our Bar Manager, Nick Murray, at nmurray@doubleclutchbrewing.com.

Charges apply to all guests 21 and older in attendance at event. We require all guests consuming alcohol to provide valid identification.





PRIVATE EVENTS

DRINK MENU

DOUBLE CLUTCH HOUSE BREWS

- Kölsch
- Altbier
- Hefeweizen
- Helles Lager
- Pilsener

Additional Double Clutch draft beers are available based on seasonality and Brewer's rotation. Please ask our Event Manager to provide what is available for your event.

GUEST TAPS

- Rotating Red, Rose and White Wine
- Rotating Eris Cider
- Rotating N/A Beer

LIQUOR

- Double Clutch Vodka
- Tito's Vodka
- Hendrick's Gin
- Captain Morgan White Rum
- Gustoso Aguardiente Aged Dark Rum
- Buffalo Trace Bourbon
- Maker's Mark
- Jim Beam Bourbon
- Double Clutch Bourbon
- Jack Daniel's Whiskey
- Jameson Irish Whiskey
- Casamigos Blanco
- El Dovejo Blanco
- Del Maguey Mezcal



PRIVATE EVENTS EXTRAS

GAMES & ACTIVITIES

- Cornhole.....\$30
- Connect Four.....\$30
- Jenga.....\$30
- Beer Pong Table.....\$40
- Polaroid Instant Print Camera.....\$30
- 360 Photo Booth (holds 5 guests)..... \$450

CATERING & FOOD ADD-ONS

Vandalay Brands owns and operates multiple North Shore and Chicago restaurants. We are able to partner with our Wilmette restaurants to provide unique experiences, including a traveling oyster bar from Pescadero Seafood & Oyster Bar, a late-night pizza bar from Napolita Pizzeria & Wine Bar, or tacos from Casa Bonita.

- Oyster Bar
- Meat Carving Table

For pricing and menu options, please reach out to our Event Manager.



TABLE RENTAL

All events have access to our typical wooden family-style tables. We have 60-inch round tables that are available to rent for \$15/table.



PRIVATE EVENTS

DCBC EXCLUSIVE VENDORS

We pride ourselves on our extensive list of amazing vendors ready to meet all your event needs! From florists to mechanical bulls, you name it, we have it!



Click below for the full list of exclusive DCBC vendors to make your event special!

[EXPLORE OUR VENDORS HERE](#)

WEDDINGS

Double Clutch venue is also equipped to create the wedding ceremony of your dreams! Click the link below to view our wedding event menu and find more info!

[EXPLORE OUR WEDDING MENU](#)





PRIVATE EVENTS

CONTRACT & TERMS

DEPOSIT

All events require a 25% deposit in order to be considered fully booked and confirmed. A credit card authorization form is required regardless of the minimum. All events are subject to cancellation charges outlined below.

FOOD AND BEVERAGE MINIMUM

All private events are subject to a food and beverage minimum, which will be noted in the contract. In specific cases, a "Venue Rental" fee will be added- this fee is tax exclusive. If the minimum is not met, the remaining balance will be charged as a "Room Rental" fee. The food and beverage minimum does not include 10.25% sales tax and 25% service charge. Any additional rentals/services do not contribute towards the food and beverage minimum.

TAX RATE

There is a 10.25 % tax on all food and beverages. Tax-exempt organizations must provide a 501(c)3 prior to booking- exemption will be reflected on the final banquet event order.

SERVICE CHARGES

There is a 25% service charge (20% gratuity + 5% administrative fee) added to the final subtotal of all private events. This service charge will not be taxed.

PAYMENT

Initial deposits will be deducted from the client's final bill. Once the event concludes, the client will be responsible for the remaining balance and shall complete payment on-site prior to leaving. Any additional items ordered during the time of event will be added to the proposed total amount. Tax and service charge will be reflective of any additional items. Final payment will NOT be divided into separate checks, however, the client may use a maximum of four credit cards to settle the single bill.

Those paying deposits with a check must deliver it in-person at Double Clutch Brewing Company.

CANCELLATIONS

A "cancellation fee" of 2% of the subtotal of the event shall be charged to the client to the credit card on file in the event an event booking is canceled, for any reason.

- If the event is canceled 30 days or more prior to the scheduled event date, you will receive your initial deposit minus the 2% cancellation fee.
- If the event is canceled 29-15 days prior to the scheduled event date, you will receive 50% of your deposit back minus the 2% cancellation fee.
- In the event of a cancellation occurring 14 days or less prior to the event date, deposits will not be refundable, but are transferable & can be applied to an event scheduled within 30-days of the original event date (date availability permitting).
- Client shall be held liable for the full contracted amount if cancellation occurs less than 72 hours from scheduled time of event.

GUARANTEE OF GUESTS

All guaranteed guest count numbers are due seven days prior to your event. All drink or meal packages will be charged per guaranteed guest count. If attendance is greater than the guest count (space permitting), the overage will be charged at the time of event. If the client does not confirm the guest count, the original number of guests, as specified on the event contract, will be utilized as the guaranteed number. Reductions in guest count will not be accepted within one week of the event.

MENU SELECTIONS

Menu selections are due 14 days prior to the event date- selections are not required upon signing the private event agreement. Changes made less than 14 days before the event date cannot be guaranteed and are based upon availability. If selections are not made by this date, the venue will have to opt for chef's choice as the chef will select a menu for you, choosing our most popular items. Happy hour & daily specials will not be available for any event.

PRIVATE EVENTS

CONTRACT & TERMS

DIETARY RESTRICTIONS

Our culinary team is happy to accommodate any serious dietary restrictions members of your party may have. Please be sure to make us aware of all restrictions when submitting your menu selections.

OUTSIDE FOOD & DESSERT

Client is prohibited to bring any food or beverage prepared outside of Double Clutch Brewing Company onto the premises. Double Clutch Brewing Company retains the right to allow for certain exceptions based on specific circumstances or if the total number of guests exceeds our food and beverage limits and we advise you to go to our preferred caterers. However, any and all arrangements must be made prior to the event with the Event Sales Manager. It is our policy that no food or beverage of any kind can be taken out of the restaurant by the client or attendees.

BEVERAGE PACKAGES

Spirits included in beverage packages are for mixed drinks only. This is defined by the combination of 1.5 oz of spirit and one non-alcoholic mixture. Shot, rocks, neat, and martini pours are not included in beverage packages.

ALCOHOLIC BEVERAGES

Double Clutch Brewing Company asks your cooperation in enforcement of applicable restrictions, particularly concerning service to minors and intoxicated individuals. We respectfully reserve the right to refuse service to any individual that appears to be intoxicated. Under no circumstances are individuals under the age of 21 permitted to consume alcoholic beverages on the premises.

FURNITURE RENTALS & VENDORS

Double Clutch Brewery offers furniture rentals for parties seeking round tables and chairs. We have a list of preferred vendors we recommend our guests use when planning their event at Double Clutch. Please check with our event manager in regards to all rentals and outside vendors.

DECORATIONS

Event guests are welcome to bring in outside décor for their event. All decorations must be discussed with the Event Sales Manager prior to the event. Free-flowing decorations such as confetti, poppers, sprinkles, sparkles, glitter, sparklers, bubbles, anything sticky or anything leaving residue etc are not permitted. Pyrotechnics and open flames are not permitted- (votive lights and enclosed candles on tables are permitted).

DAMAGE WAIVER

Double Clutch Brewing Company does not assume any liability for the damage to or loss of any articles left on the premises before, during or after your event. Examples of this include but are not limited to: event décor, floral, and desserts.

EVENT SET-UP TIME

The event space will be ready 30-minutes prior to your event start time. If you need additional time, please contact the Event Sales Manager- additional fees may be added.

LIVE MUSIC

Please see our website for the live music schedule. Personal entertainment is allowed for full venue buyouts only.

PARKING

Double Clutch Brewing has a small parking lot attached to the building. There is also plenty of street parking and neighborhood parking lot. The parking lot next to DCBC is not ours and is not permitted for use.

PUBLIC HEALTH/PANDEMIC RESTRICTIONS

For the safety of all attendees, please be aware that your event may be subject to cancellation based on local regulations in effect at the time. In the event that the City of Evanston imposes restrictions on the size of gatherings due to public health concerns, all payments and deposits made will be fully refunded. However, if there are no specific restrictions in place for the size of your event, our regular cancellation policy will apply. If a regulation is in effect for your group size but is later lifted before your event, we will promptly inform you. In such a case, a deposit will be required within seven days of receiving our notification.



PRIVATE EVENTS

FREQUENTLY ASKED QUESTIONS

WHAT ARE THE PRICES FOR AN EVENT?

Each event is subject to a food and beverage minimum, which will be noted in the contract, and is listed on the specific space profiles within this document. The food and beverage minimum does not include 10.25% sales tax and 25% service charge. If the food and beverage minimum is not met in food and beverage charges, the remaining amount will be charged as a "room rental" fee.

For parties of 30 or less, we do not require a food and beverage minimum. These parties are not considered private and are not closed off from other restaurant patrons. For parties of 15 or less, we recommend the Brewpub as your event space.

HOW CAN I HOLD A SPACE FOR AN EVENT?

We do not provide an option to place a "hold" on an event space. In order to be considered fully booked we require a signed contract, the provided CC authorization form completed, and a 25% deposit on the proposal/contract.

WILL I BE REQUIRED TO SIGN A CONTRACT?

Yes, you will be required to sign a contract to book the space(s).

IS SECURITY AVAILABLE?

Armed Security is required for all events of more than 100 people and is an additional \$80 per guard per hour- this will be reflected in your contract. There will be one (1) Guard per 100 people, and one (1) additional guard per each additional 150 People. Armed security is optional for parties of less than 100 guests.

Example 100 People- 1 guard, 250 people- 2 guards, 400 people- 3 guards, etc.

CAN I USE MY OWN VENDORS?

We have established great connections with a variety of vendors in the area. These are our vendors that you are able to use for any of your event needs. Vendors are only subject to our preferred vendors- please see "preferred vendors" page for a complete list. Additional vendors are subject to approval on a case-by-case basis for more specialized needs.

IS A DEPOSIT REQUIRED? IS MY DEPOSIT REFUNDABLE?

Yes, a 25% deposit is required on the "event room" fee, or the proposal total-dependent on if the total number of guests exceeds our food and beverage limits. Please see the cancellation policy in regards to cancellations/refunds.

CAN OTHER EVENTS TAKE PLACE IN THE BUILDING AT THE SAME TIME AS MY EVENT?

If you do not elect to rent a full-venue buyout, then we cannot guarantee that other events/the public will not be in different areas of the restaurant/venue.

CAN WE RENT THE PARKING LOT EXCLUSIVELY FOR OUR GUESTS?

Our parking lot is available to rent for your event. If you want to reserve the parking lot exclusively for your event, it would be an additional \$500 charge, which includes staff two hours before the event and one hour after the event to monitor the cars.

CAR REMOVAL FEE

In the event that we need to remove cars for an event or at the clients requests a fee of \$500+ will be added to the final bill to compensate for the labor of the removal. If you have any questions please ask the event coordinator.